

Brooks® Model 2500 Series Flowmeters



Description

Series 2500 is a standard precision-machined acrylic flow meter for liquids and gases, has direct reading air or water scales and is available in either English or metric scales.

Models 2510/2520/2530 can be configured with a control valve on the inlet or no valve. Fittings and valve can be specified in either brass or stainless steel. O-rings are available in either Buna-N, Viton® fluoroelastomer or other optional elastomers. Model 2540 flowmeters have 1" FNPT PVC fittings with either an in-line Model 2540-I or panel mount Model 2540-S configuration. The panel mount version is available with an integral valve on the inlet Model 2540-V or no valve.

Features

- Easy-to-read English or metric scales
- Water ranges from 4 ccm to 20 GPM
- Air ranges from 40 ccm to 4000 LPM
- Threaded brass inserts for quick installation
- Easy disassembly and assembly for maintenance
- Durable one-piece clear acrylic construction
- Stable easy-to-read float
- Superior quality

Applications

- Air sampling equipment aquaculture
- Desalinization equipment
- Gas analyzers
- Medical systems
- Photo processing equipment
- Water treatment and distribution systems

Specifications

- Accuracy:** Model 2510 $\pm 5\%$ full scale
 Model 2520,30 $\pm 3\%$ full scale
 Model 2540 $\pm 2\%$ full scale
- Floats:** Black Glass, Stainless Steel, Delrin® Acetal Resins
- Body:** Clear Acrylic
- Seals:** Buna-N O-rings with Brass or PVC fittings
 Viton® O-rings with Stainless Steel fittings
- Pressure:** 100 PSIG Max.
- Temp.:** 150°F/65°C Max.
- Fittings:** Brass, Stainless Steel or PVC
 FNPT Pipe Connections
- Valves:** Models 2510/2520/2530
 Brass or Stainless Steel
 Model 2540
 Integral Valve on "V" models
 Inline Gate Valve is available for "S and I" models

Models 2510/2520/2530 Flowmeter

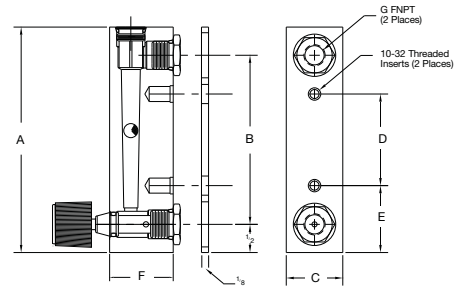

Dimensions inches/millimeters (mm)

MODEL	A	B	C	D	E	F	G
2510	4" (102)	3" (76.2)	1" (25.4)	1 5/8" (41.3)	1 3/16" (30.2)	1 1/8" (28.6)	1/8"
2520	6 1/2" (165)	5 1/2" (140)	1 3/8" (34.9)	3 1/2" (88.9)	1 1/2" (38.1)	1 1/8" (28.6)	1/8"
2530	6 5/8" (168)	5 1/2" (140)	1 1/8" (28.6)	3 1/2" (88.9)	1 1/2" (38.1)	1 3/8" (34.9)	1/4"

* Does not include 1/8" back plate

Model 2540-S or V

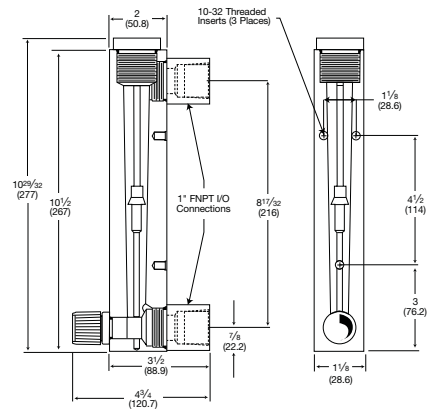

Model 2540-I

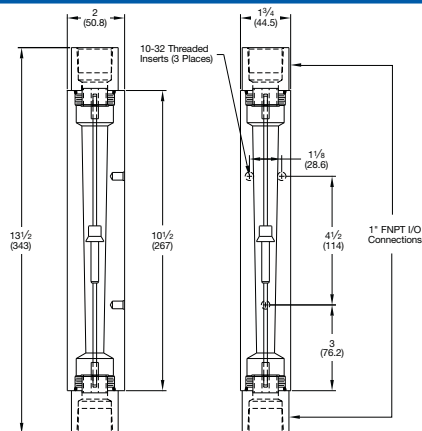

Model 2510 Flow Rates Table A**

Range SCFH of Air	Tube Code	Range LPM of Air	Tube Code
.1-1	2A00	.04-.5	2A12
.2-2	2A01	.1-1	2A13
.4-5	2A02	.2-2.5	2A29
1-10	2A03	.4-5	2A14
2-20	2A04	1-10	2A15
3-30	2A05	2-25	2A16
4-50	2A06	4-50	2A17
10-100	2A07	10-100	2A18
20-200	2A08		
CCM of Water		GPH of Water	
5-50	2L09	.2-2	2L28
10-100	2L10	.4-5	2L19
20-240	2L11	1-10	2L20
		2-20	2L21
		4-40	2L22

Model 2520 Flow Rates Table B**

Range SCFH of Air	Tube Code	Range CCM of Water	Tube Code
.4-5	4A30	4-50	4L38
1-10	4A31	10-120	4L56
2-20	4A32	25-225	4L51
4-40	4A33	40-400	4L50
10-100	4A34	40-660	4L52
14-150	4A35	100-1500	4L53
20-200	4A36	200-3000	4L54
CCM of Air		300-3700	4L55
LPM of Air		GPH of Water	
.4-5	4A40	1-10	4L45
1-10	4A41	2-25	4L48
2-20	4A42	4-50	4L49
3-30	4A43	6-60	4L46
SCFM of Air		SCFM of Air	
4-50	4A44	.3-3	4A37
10-100	4A47		

*Uses Delrin® Acetal Resins float
 ** Available with millimeter scales. Flow curves for a variety of gases and liquids for specific applications may also be ordered.

Model 2530 Flow Rates Table C

Range SCFH of Air	Tube Code	Range GPM of Water	Tube Code
.5-5	4A67	.2-2.5	4L64
1-10	4A65	.4-5	4L66
*2-20	4A68		
LPM of Air		LPM of Water	
14-140	4A72	1-10	4L69
30-280	4A70	1.5-20	4L71
*60-560	4A73		

Dual scales: SCFM/SCFH, GPM/GPH, and LPM/ LPH

* Not Available with Valves

Model 2540 - S or V Flow Rates Table D

Range SCFH of Air	Tube Code	Range GPM of Water	Tube Code
3-25	5A50	.4-5	5L56
4-50	5A51	1-10	5L57
10-100	5A52	2-20	5L58
LPM of Air		LPM of Water	
100-700	5A53	1-19	5L59
100-1400	5A54	4-36	5L60
400-3400	5A55	5-75	5L61

Model 2540 - I Flow Rates Table E

Range SCFH of Air	Tube Code	Range GPM of Water	Tube Code
3-25	5A50	.4-5	5L56
4-50	5A51	1-10	5L57
10-100	5A52	2-20	5L58
LPM of Air		LPM of Water	
100-700	5A53	1-19	5L59
100-1400	5A54	4-36	5L60
400-4000	5A55	5-75	5L61

Periodically, product revisions occur. Please consult the factory for the latest specifications.

Ordering Information Models 2510/2520/2530

Catalog Number Ordering Example: **2510A2A04BVBN**

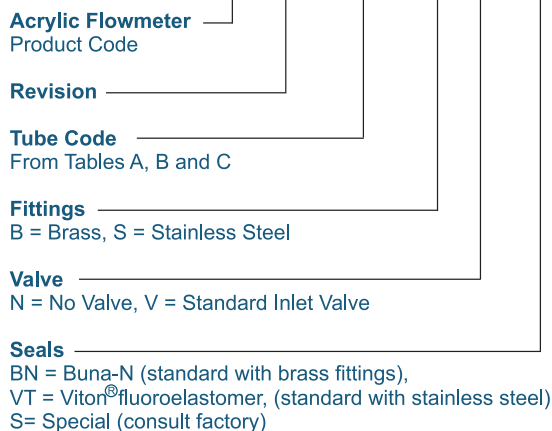

Catalog Number Ordering Example: **2520A4A30SNVT**

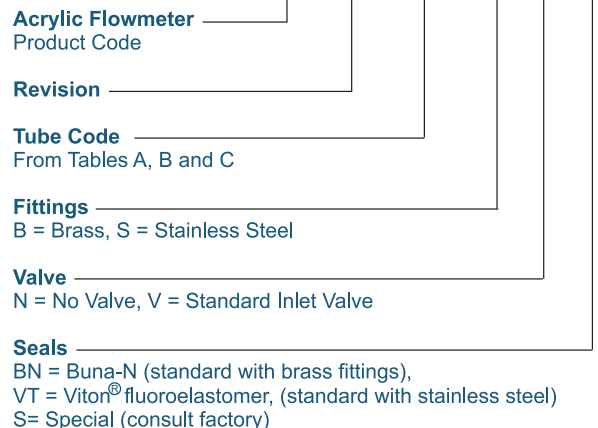

Ordering Information Model 2540

Catalog Number Ordering Example: **2540A5A53PV**

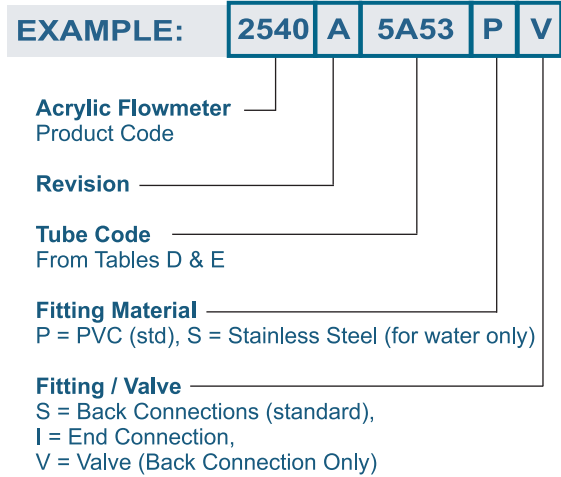

Catalog Number Ordering Example: **2540A5L57SI**

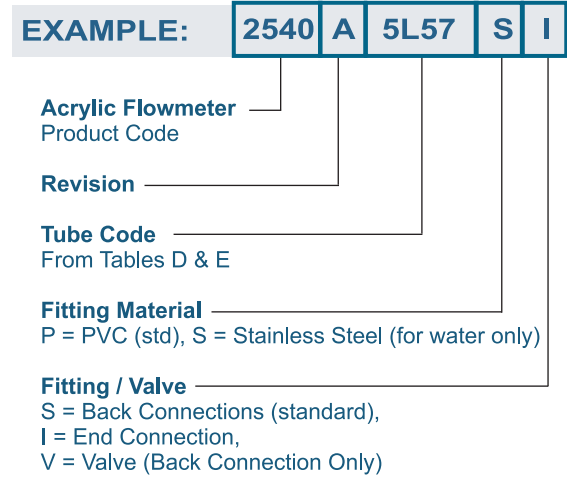

TRADEMARKS
 Brooks Brooks Instrument, LLC
 Delrin E. I. DuPont Nemours and Co.
 Viton DuPont Performance Elastomers

Brooks Instrument
 407 West Vine Street
 P.O. Box 903
 Hatfield, PA 19440-0903 USA
 T (215) 362 3700
 F (215) 362 3745
 E-Mail BrooksAm@BrooksInstrument.com
www.BrooksInstrument.com

Brooks Instrument
 Neonstraat 3
 6718 WX Ede, Netherlands
 T +31 (0) 318 549 300
 F +31 (0) 318 549 309
 E-Mail BrooksEu@BrooksInstrument.com

Brooks Instrument
 1-4-4 Kitasuna Koto-Ku
 Tokyo, 136-0073 Japan
 T +81 (0) 3 5633 7100
 F +81 (0) 3 5633 7101
 E-Mail BrooksAs@BrooksInstrument.com

