

SERIES TD 100 | SWITCH OVER BOARD

- Diaphragm single stage
- Purity up to 6.0
- Inlet pressure:
200 bar (2900 psi)
- Outlet pressure:
10/25/50 bar
145/363/725 psi
- NH₃ version:
P1 = 8 bar (116 psi)
P2 = 3 bar (43.5 psi)

- ★ 2 duoblocs
- ★ 2 x 3 inlets/1 outlet
- ★ 2 inlets/1 outlet pressure gauges
- ★ 1 safety relief valve
- ★ 2 purge outlets
- ★ Semi-automatic and Manual Version available
- ★ Regulation done by 2 x S 220 regulators
- ★ Only in stainless steel

Special requirements on request

APPLICATIONS

- Ideally suited for corrosive gases and high purity applications for low flow applications.
- Dedicated to the supply of gas to analyzers and to the creation of controlled atmosphere in laboratories, control units.

KEY FEATURES

- Possible to manage 4 gas cylinders without any extension and a gas for purging operation (up to 6 cylinders without any extension - without using the purge line).
- No risk that a source flows into the other one.
- Exists in Manual and Semi-automatic versions.

- Ready to install with all components are mounted on a board.
- Can be equipped with a collectable tube on the safety relief valve and purge outlet.
- Can also be equipped with an outlet shut-off valve.
- Using contact gauges, the switch over board can also be equipped with an alarm box to indicate the source status.
- NH₃ version available:
P1 = 8 bar/P2 = 3 bar/Q = 5 Nm³/h.



TDI 103 Manual version



TDI 102 Semi-automatic version

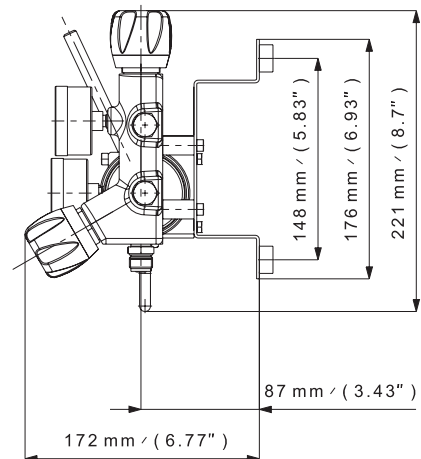
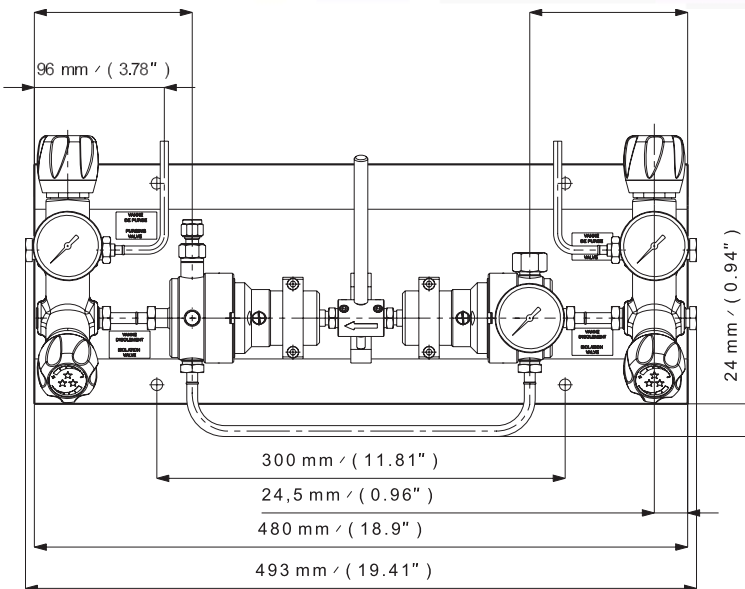

SPECIFICATIONS

Female ports	G 3/8 (inlet/outlet) or 1/4 NPT (inlet/outlet)	Weight	± 15,0 kg ± 33.0 lbs	Inlet pressure	200 bar (2900 psi) NH ₃ : 8 bar (116 psi)
Seat seal	PCTFE	Leak rate	10 ⁻⁸ mbar ℓ/s He	Outlet pressure	10/25/50 bar 145/363/725 psi NH ₃ : 3 bar (43.5 psi)
O-ring	EPDM - standard NBR FPM	Temperature range	-20°C to + 60°C -4°F to + 140°F	Nominal Flow	10/10/50 Nm ³ /h (N ₂) NH ₃ : 5 Nm ³ /h (NH ₃)
Diaphragm	Hastelloy®	Gauges	High and low pressure (M10 x 1 or 1/8 NPT)	Oxygen use	No

FLOW CURVES

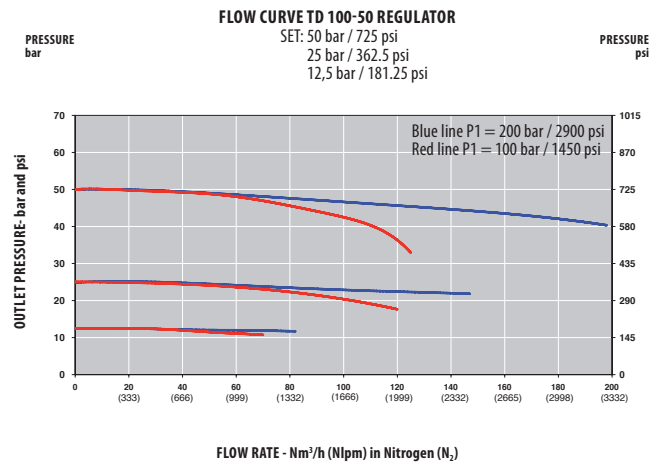
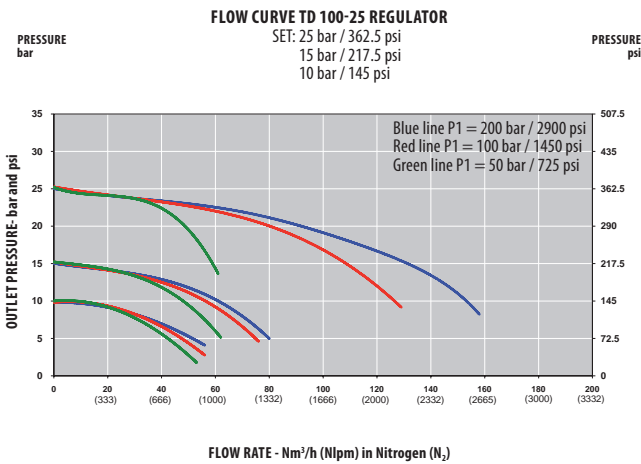

PRODUCT CONFIGURATOR

Body Material	Version Type	Outlet Pressure	End Connections	O-ring Material	Gauges	Outlet Valve	Configuration
Stainless steel	TDI Semi-automatic	102 10 bar / 145 psi	10 G 3/8 - Female	G EPDM - standard	1 with gauges - standard	1 without outlet shut-off valve (standard)	NV Standard configuration
	manual (10 bar version)	103 25 bar / 362.5 psi	25 NPT 1/4 - Female	N NBR	2 with HP inductive contact gauge	2 with outlet shut-off valve	V with connected purge and safety valve
		50 bar / 725 psi	50	FPM	3 with HP sliding contact gauge		
		Ammonia special version (P2 = 3 bar)	NH3		4 with LP inductive contact gauge		
					5 with LP sliding contact gauge		
					6 with HP & LP sliding contact gauges		CL